

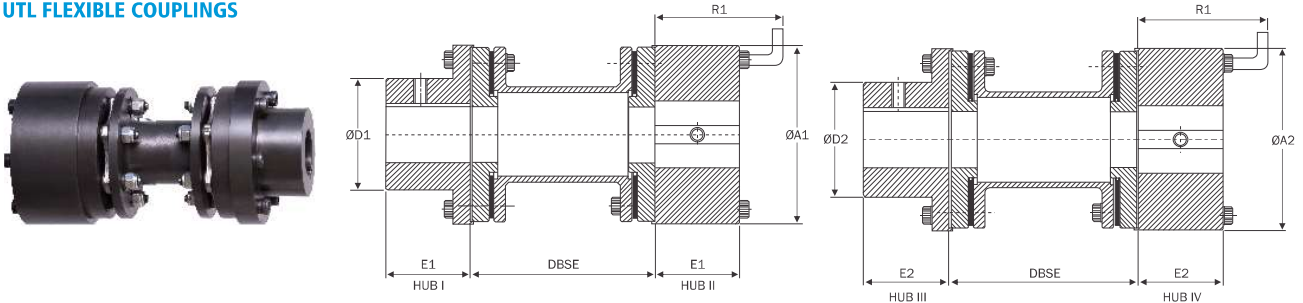

UTL FLEXIBLE COUPLINGS



FEATURES

- Power to weight ratio high
- Accommodates angular and axial misalignments
- High temperature application
- Visual inspection is possible without dismantling equipments
- Low axial stiffness with high torsional rigidity
- High-speed capacity
- Range up to 13367 Nm
- Added advantage of stretch fitted shim pack
- **API 671 compliance available on request**
- **API 610 compliance available on request**

DIMENSIONS & TECHNICAL DATA

Dimensions are in mm

| Size | Rated Torque Nm | kW at 100 rpm | Max. Speed rpm | Dimensions | | | | | | | | | | | | | | Weight in kg Approx | | Moment of Inertia kgm ² Approx | | Tors. Stiffness radial Approx |
|------|-----------------|---------------|----------------|------------|-------|--------|---------|--------|-----------|-----------|-----|-----|-----|-----|-----|-----|-----|---------------------|----------------------|---|----------------------|-------------------------------|
| | | | | Min. Bore | Hub I | Hub II | Hub III | Hub IV | Min. DBSE | Std. DBSE | E1 | E2 | ØA1 | ØA2 | ØD1 | ØD2 | R1 | Min. Std. "DBSE" | Per Mtr Extra "DBSE" | Min. Std. "DBSE" | Per Mtr Extra "DBSE" | |
| 4 | 33 | 0.35 | 7500 | 8 | 19 | 32 | 24 | 42 | 55 | | 25 | 30 | 61 | 69 | 32 | 40 | 70 | 1.30 | 1.20 | 0.001 | 0.0001 | 0.016 |
| 8 | 64 | 0.67 | 7500 | 10 | 22 | 25 | 38 | 48 | 65 | 100 | 30 | 40 | 69 | 86 | 40 | 55 | 80 | 1.20 | 1.30 | 0.001 | 0.0002 | 0.030 |
| 25 | 160 | 1.67 | 7000 | 12 | 30 | 38 | 48 | 72 | 70 | 140 | 40 | 45 | 90 | 108 | 55 | 70 | 90 | 3.76 | 2.41 | 0.0038 | 0.0005 | 0.025 |
| 65 | 515 | 5.4 | 6000 | 17 | 40 | 50 | 65 | 92 | 80 | 180 | 45 | 55 | 108 | 135 | 70 | 86 | 105 | 6.00 | 2.70 | 0.009 | 0.0009 | 0.040 |
| 125 | 860 | 9 | 5200 | 17 | 52 | 70 | 80 | 104 | 90 | | 55 | 60 | 135 | 155 | 86 | 108 | 120 | 11.10 | 7.00 | 0.030 | 0.0005 | 0.095 |
| 165 | 1337 | 14 | 4800 | 22 | 65 | 80 | 90 | 120 | 120 | | 60 | 70 | 152 | 179 | 108 | 130 | 125 | 17.00 | 8.40 | 0.060 | 0.0088 | 0.170 |
| 370 | 2388 | 25 | 4400 | 37 | 80 | 100 | 108 | 142 | 130 | 140 | 70 | 90 | 182 | 200 | 130 | 158 | 135 | 28.40 | 13.10 | 0.130 | 0.0213 | 0.300 |
| 390 | 3342 | 35 | 4200 | 32 | 90 | 115 | 127 | 155 | 130 | 180 | 90 | 95 | 197 | 222 | 158 | 181 | 155 | 38.30 | 12.82 | 0.234 | 0.0360 | 0.430 |
| 790 | 5060 | 53 | 4000 | 42 | 105 | 130 | 140 | 178 | 135 | 250 | 95 | 105 | 225 | 250 | 181 | 206 | 160 | 53.18 | 19.21 | 0.418 | 0.0530 | 0.600 |
| 1025 | 7161 | 75 | 3800 | 47 | 115 | 140 | 155 | 192 | 140 | | 105 | 115 | 250 | 275 | 206 | 223 | 170 | 74.40 | 27.10 | 0.700 | 0.0670 | 0.800 |
| 1425 | 10025 | 105 | 3700 | 52 | 120 | 155 | 170 | 212 | 150 | 180 | 115 | 130 | 175 | 300 | 223 | 248 | 190 | 98.63 | 34.60 | 1.134 | 0.1400 | 1.100 |
| 1880 | 13367 | 140 | 3600 | 62 | 135 | 165 | 190 | 255 | 175 | 250 | 130 | 145 | 300 | 375 | 248 | 280 | 215 | 128.10 | 42.80 | 1.700 | 0.1600 | 1.500 |

• For non standard DBSE please contact UTL

MATERIAL SPECIFICATIONS

| | | | | |
|-----------|-----------------|-----------------|----|------------------|
| Hub | Size - 4 - 1880 | Steel C 40 | St | EN/DIN 10263 - 2 |
| Spacer | Size - 4 - 1880 | Steel C 40 | St | EN/DIN 10263 - 2 |
| Disc Pack | Size - 4 - 1880 | Stainless Steel | SS | |



• For temperature range of elastomers please see on page no. 37 - coupling selection

