

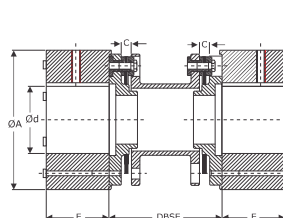

**RSV** Industries Pvt. Ltd.

## UTL UMSR2 COUPLINGS (Metalflex Couplings Antifly Design)

### UTL FLEXIBLE COUPLINGS



Size : 35

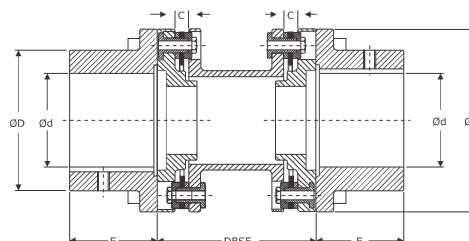

Size : 50-160

### FEATURES

- Series for pump drives
- Coupling in accordance with **API 610, API 671 optionally**
- Available with large hub for bigger bore diameters
- Spacers are supplied assembled by the manufacturer
- Finish bore according to ISO fit H7, feather key according to DIN 6885 sheet 1 - JS9

### DIMENSIONS & TECHNICAL DATA

Size	Rated Torque Nm	Max. Torque Nm	Vibratory Torque kW	Dimensions are in mm										Wt in. Kg	Moment of Inertial (kg.m2)
				Max. Bore Ød	ØD	ØA	E	C	DBSE						
35	60	120	30	50	-	75	38.5	6	100	140	-	-	-	On request UTL will provide data.	On request UTL will provide data. According to spacer length.
50	240	480	120	50	70	95	50	9	100	140	-	-	-		
65	450	900	225	65	100	126	63	10	100	140	180	-	-		
75	940	1880	470	75	105	138	62.5	10	100	140	180	-	-		
85	1700	3400	850	85	120	156	72.5	12	-	140	180	200	250		
110	2700	5400	1350	110	152	191	87	12	-	140	180	200	250		
120	4500	9000	2250	120	165	213	102	12	-	-	180	200	250		
140	9000	18000	4500	140	200	265	126	15	-	-	-	200	250		
160	13000	26000	6500	160	230	305	145	15	-	-	-	-	250		

• For non standard DBSE please contact UTL

### MATERIAL SPECIFICATIONS

Hub	Size - 35 - 160	Steel C 40	St	EN/DIN 10263 - 2
Spacer	Size - 35 - 160	Steel C 40	St	EN/DIN 10263 - 2
Disc Pack	Size - 35 - 160	Stainless Steel	SS	



• For temperature range of elastomers please see on page no. 37 - coupling selection



**RSV** Industries Pvt. Ltd.

[www.rsvindustries.com](http://www.rsvindustries.com)

[sales@rsvindustries.com](mailto:sales@rsvindustries.com)

+91 74004 33355